

## SAFETY PRECAUTIONS



### CAUTION

**RISK OF ELECTRIC SHOCK  
DO NOT OPEN**



**CAUTION:** TO REDUCE THE RISK OF ELECTRIC SHOCK, DO NOT REMOVE COVER (OR BACK). NO USER-SERVICEABLE PARTS INSIDE. REFER SERVICING TO QUALIFIED SERVICE PERSONNEL.



### DANGEROUS VOLTAGE

Uninsulated Dangerous Voltage, that may be of sufficient magnitude to constitute a risk of electric shock to persons is present within this product's enclosure.



### ATTENTION

The Owner's Manual contains important operating and maintenance instructions.

For your safety, it is necessary to refer to the manual.

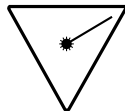

### DANGER:

Invisible and hazardous laser radiation when open and interlock failed or defeated. Avoid direct exposure to beam.

### FCC WARNING:

This equipment may generate or use radio frequency energy. Changes or modifications to this equipment may cause harmful interference unless the modifications are expressly approved in the instruction manual. The user could lose the authority to operate this equipment if an unauthorized change or modification is made.

**LASER SAFETY:** This unit employs a laser. Only qualified service personnel should attempt to service this device due to possible eye injury.

**CAUTION:** USE OF CONTROLS, ADJUSTMENTS OR PERFORMANCE PROCEDURE HEREIN MAY RESULT IN HAZARDOUS RADIATION EXPOSURE.

**SPLASH RESISTANT:** DO NOT use this unit under direct water flow. This unit is splash resistant, meaning it can withstand small splashes of water.

**INFORMATION**

This equipment has been tested and found to comply with the limits for a Class B digital device, pursuant to Part 15 of the FCC Rules. These limits are designed to provide reasonable protection against harmful interference in a residential installation. This equipment generates, uses, and can radiate radio frequency energy and, if not installed and used in accordance with instructions, may cause harmful interference to radio communications. However, there is no guarantee that interference will not occur in a particular installation. If this equipment does cause harmful interference to radio or television reception, which can be determined by turning the equipment off and on, the user is encouraged to try to correct the interference by one or more of the following measures:

- Reorient or relocate the receiving antenna.
- Increase the separation between the equipment and receiver.
- Connect the equipment into an outlet on a circuit different from that to which the receiver is connected.
- Consult the dealer or an experienced radio/TV technician for help.

**IMPORTANT SAFETY INSTRUCTIONS**

**Before using the unit, be sure to read all operating instructions carefully. Please note that these are general precautions and may not pertain to your unit. For example, this unit may not have the capability to be connected to an outdoor antenna.**

**1. READ INSTRUCTIONS**

All the safety and operating instructions should be read before the product is operated.

**2. RETAIN INSTRUCTIONS**

The safety and operating instructions should be retained for future reference.

**3. HEED WARNINGS**

All warnings on the product and in the operating instructions should be adhered to.

**4. FOLLOW INSTRUCTIONS**

All operating and use instructions should be followed.

**5. CLEANING**

Unplug this product from the wall outlet before cleaning. Do not use liquid cleaners or aerosol cleaners. Use a damp cloth for cleaning.

**6. ATTACHMENTS**

Do not use attachments not recommended by the product's manufacturer as they may cause hazards.

**7. WATER AND MOISTURE**

Do not use this product near water- for example, near a bathtub, washbowl, kitchen sink, or laundry tub, in a wet basement, or near a swimming pool.

**8. ACCESSORIES**

Do not place this product on an unstable cart, stand, tripod, bracket, or table. The product may fall, causing serious injury and serious damage to the product. Use only with a cart, stand, tripod, bracket, or table recommended by the manufacturer or sold with the product. Any mounting of the product should follow the manufacturer's instructions, and should use a mounting accessory recommended by the manufacturer.

**8A. An appliance and cart combination**

should be moved with care. Quick stops, excessive force, and uneven surfaces may cause the appliance and cart combination to overturn.

PORTABLE CART WARNING  
(symbol provided by RETAC)



**9. VENTILATION**

Slots and openings in the cabinet and in the back or bottom are provided for ventilation and to ensure reliable operation of the product and to protect it from overheating. These openings must not be blocked or covered. The openings should never be blocked by placing the product on a bed, sofa, rug, or other similar surface. This product should never be placed near or over a radiator or heat source. This product should not be placed in a built-in installation such as a bookcase or rack unless proper ventilation is provided or the manufacturer's instructions have been adhered to.

**10. POWER SOURCES**

This product should be operated only from the

## IMPORTANT SAFETY INSTRUCTIONS

type of power source indicated on the marking label. If you are not sure of the type of power supply to your home, consult your appliance dealer or local power company. For products intended to operate from battery power, or other sources, refer to the operating instructions.

**11. GROUNDING OR POLARIZATION**

This product is equipped with a polarized alternating-current line plug (a plug having one blade wider than the other). This plug will fit into the power outlet only one way. This is a safety feature. If you are unable to insert the plug fully into the outlet, try reversing the plug. If the plug should still fail to fit, contact your electrician to replace your obsolete outlet. Do not defeat the safety purpose of the polarized plug.

**12. POWER-CORD PROTECTION**

Power-supply cords should be routed so that they are not likely to be walked on or pinched by items placed upon or against them, paying particular attention to cords at plugs, convenience receptacles, and the point where they exit from the appliance.

**13. LIGHTNING**

To protect your product from a lightning storm, or when it is left unattended and unused for long periods of time, unplug it from the wall outlet and disconnect the antenna or cable system. This will prevent damage to the product due to lightning and power-line surges.

**14. POWER LINES**

An outside antenna system should not be located in the vicinity of overhead power lines or other electric light or power circuits, or where it can fall into such power lines or circuits. When installing an outside antenna system, extreme care should be taken to keep from touching such power lines or circuits as contact with them might be fatal.

**15. OVERLOADING**

Do not overload wall outlets and extension cords as this can result in a risk of fire or electric shock.

**16. OBJECT AND LIQUID ENTRY**

Never push objects of any kind into this product through openings as they may touch dangerous voltage points or short out parts that could result in fire or electric shock. Never spill or spray any type of liquid on the product.

**17. SERVICING**

Do not attempt to service this product yourself as opening or removing covers may expose you to dangerous voltage or other hazards. Refer all servicing to qualified service personnel.

**18. REPLACEMENT PARTS**

When replacement parts are required, be sure the service technician uses replacement parts specified by the manufacturer or those that have the same characteristics as the original part. Unauthorized substitutions may result in fire, electric shock or other hazards.

**19. SAFETY CHECK**

Upon completion of any service or repairs to this product, ask the service technician to perform safety checks to determine that the product is in proper operating condition.

**20. WALL OR CEILING MOUNTING**

The product should be mounted to a wall or ceiling only as recommended by the manufacturer.

**21. DAMAGE REQUIRING SERVICE**

Unplug the product from the wall outlet and refer servicing to qualified service personnel under the following conditions:

- a. When the power-supply cord or plug is damaged.
- b. If liquid has been spilled, or objects have fallen into the product.
- c. If the product has been exposed to rain or water.
- d. If the product does not operate normally by following the operating instructions. Adjust only those controls that are covered by the operating instructions, as an adjustment of other controls may result in damage and will often require extensive work by a qualified technician to restore the product to its normal operation.
- e. If the product has been dropped or the cabinet has been damaged.
- f. When the product exhibits a distinct change in performance - this indicates a need for service.

**22. HEAT**

The product should be situated away from heat sources such as radiators, heat registers, stoves, or other products (including amplifiers) that produce heat.

**23. NOTE TO CATV SYSTEM INSTALLER**

This reminder is provided to call the CATV system installer's attention to Article 820-40 of the NEC that provides guidelines for proper grounding and, in particular, specifies that the cable ground shall be connected to the grounding system of the building, as close to the point of cable entry as practical.

**24. NONUSE PERIODS**

The power cord of the appliance should be unplugged from the outlet when left unused for a long period of time.

**Dear Customer:**

Selecting fine audio equipment such as the unit you've just purchased is only the start of your musical enjoyment. Now it's time to consider how you can maximize the fun and excitement your equipment offers. This manufacturer and the Electronic Industries Association's Consumer Electronics Group want you to get the most out of your equipment by playing it at a safe level. One that lets the sound come through loud and clear without annoying blaring or distortion—and, most importantly, without affecting your sensitive hearing. Sound can be deceiving. Over time your hearing "comfort level" adapts to higher volumes of sound. So what sounds "normal" can actually be loud and harmful to your hearing. Guard against this by setting your equipment at a safe level BEFORE your hearing adapts.

**To establish a safe level:**

- Start your volume control at a low setting.
- Slowly increase the sound until you can hear it comfortably and clearly, and without distortion.

**Once you have established a comfortable sound level:**

- Set the dial and leave it there.

Taking a minute to do this now will help to prevent hearing damage or loss in the future. After all, we want you listening for a lifetime.

**We Want You Listening For A Lifetime**

Used wisely, your new sound equipment will provide a lifetime of fun and enjoyment. Since hearing damage from loud noise is often undetectable until it is too late, this manufacturer and the Electronic Industries Association's Consumer Electronics Group recommend you avoid prolonged exposure to excessive noise. This list of sound levels is included for your protection.

**Decibel**

<u>Level</u>	<u>Example</u>
30	Quiet Library, soft whispers
40	Living room, refrigerator, bedroom away from traffic
50	Light traffic, normal conversation, quiet office
60	Air conditioner at 20 feet, sewing machine
70	Vacuum cleaner, hair dryer, noisy restaurant
80	Average city traffic, garbage disposals, alarm clock at two feet

**THE FOLLOWING NOISES CAN BE DANGEROUS UNDER CONSTANT EXPOSURE:**

90	Subway, motorcycle, truck traffic, lawn mower
100	Garbage truck, chain saw, pneumatic drill
120	Rock band concert in front of speakers, thunderclap
140	Gunshot blast, jet engine
180	Rocket launching pad

Information courtesy of the Deafness Research Foundation.



## LOCATION OF CONTROLS

**TOP**

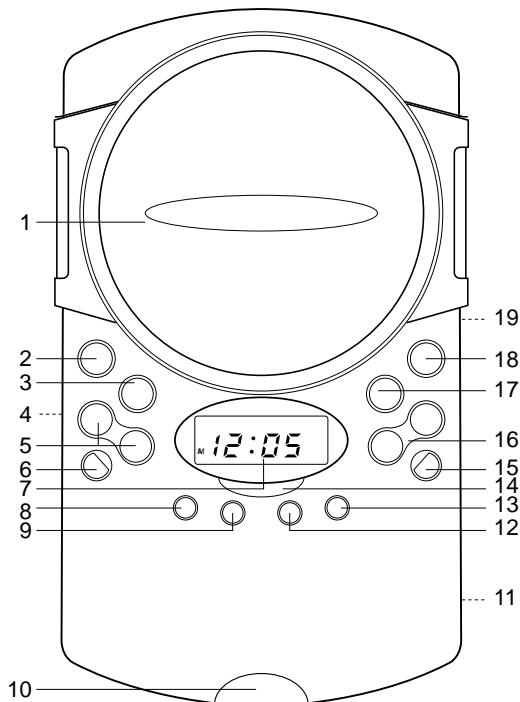

- |                                    |  |
|------------------------------------|--|
| 1. CD Compartment                  | 8. REPEAT Button                             |
| 2. PLAY/PAUSE (▶  ) Button         | 9. MEMORY Button                             |
| 3. STOP (■) Button                 | 10. LIGHT Button                             |
| 4. Jacks (Side of Unit)            | 11. Battery Compartment (Rear of Unit)       |
| Headphone Jack                     | 12. SLEEP Button                             |
| AUX IN                             | 13. FUNCTION Button                          |
| DC 9V Jack ⊖ — ⊕                   | 14. POWER Button                             |
| 5. TUNING/TIME SET UP/DOWN Buttons | 15. CD DISPLAY Button                        |
| CD SKIP/SEARCH (◀◀) / (▶▶) Buttons | 16. VOLUME Up/Down Buttons                   |
| 6. RANDOM Button                   | 17. BAND Button                              |
| 7. Display                         | 18. MEMORY UP Button                         |
|                                    | 19. External FM Antenna Screw (Side of Unit) |

## INSTALLATION

**SPLASH RESISTANT: DO NOT** use this unit under direct water flow. This unit is splash resistant, meaning it can withstand small splashes of water.

### MOUNTING ON THE BASE

To use this unit with the supplied base, simply place the unit on the hub as shown in the illustration, then gently push it backwards so it snaps in place.

To remove unit from base, simply press in on the tab located at the rear of the base and lift up the unit.

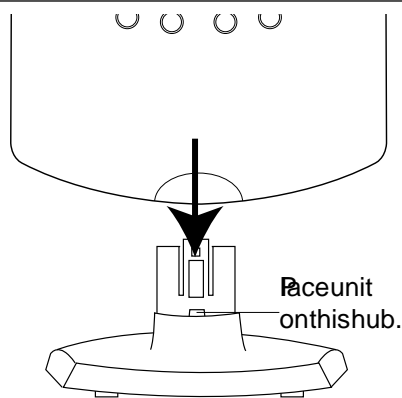

### HANGER MOUNTING

To mount this unit with the supplied hanger, simply place the unit on the hanger as shown in the illustrations below.

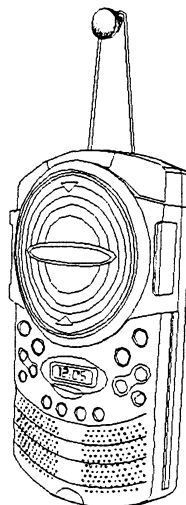
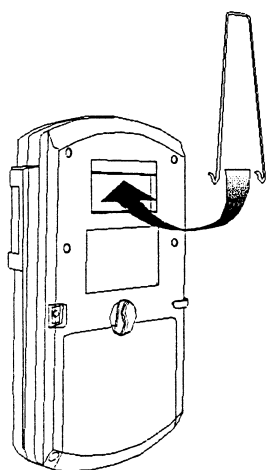

## INSTALLATION

### SHOWER CURTAIN BAR MOUNTING

To mount this unit with the supplied curtain hanger, simply place the unit on the curtain hanger as shown in the illustrations below.

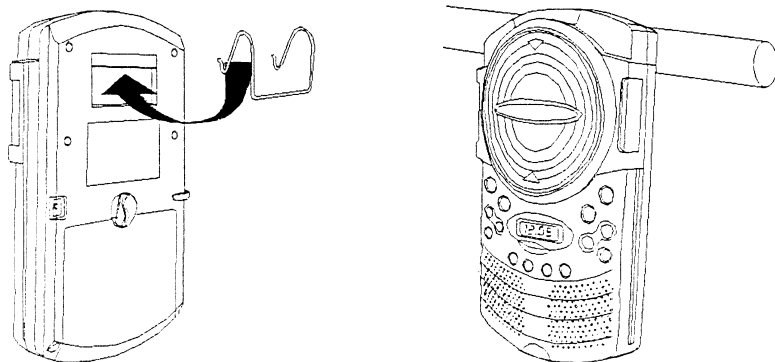

### WALL MOUNTING

To mount this unit on a wall, simply screw the supplied wall mount to a wall (see illustration below), making sure to either go through a stud, or use anchors. Place the unit on the wall mount as shown in the illustration.

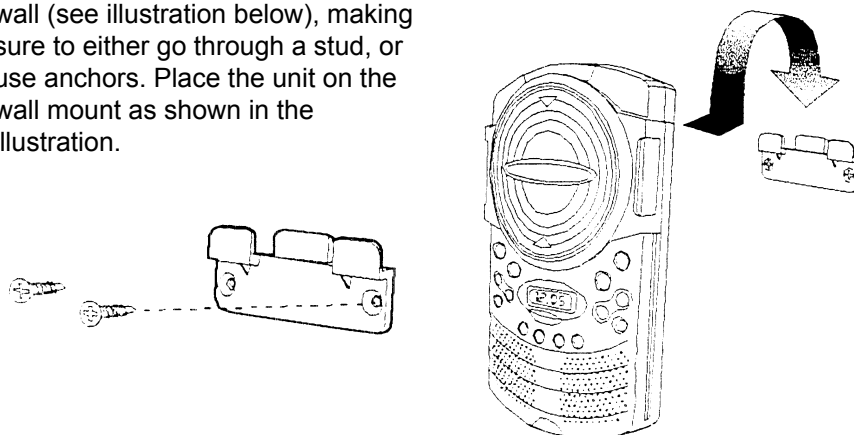

### HEADPHONE JACK:

Plug headphones with a 3.5mm plug into this jack for private listening.

### LIGHT:

To light up the display, press the LIGHT button.

## POWER SOURCES

This CD player requires either 6 “C” cell batteries (not included) or a 9V AC adapter having a positive center.

### BATTERY INSTALLATION

1. Make sure the unit is not on the base. Open the battery compartment door by rotating the tab, then lift the battery compartment off.
2. Insert six (6) “C” cell batteries (not included) as shown in the illustration to the right. Alkaline batteries are recommended for the longest playing time.
3. Replace the battery compartment cover and rotate the tab so the compartment is secured.

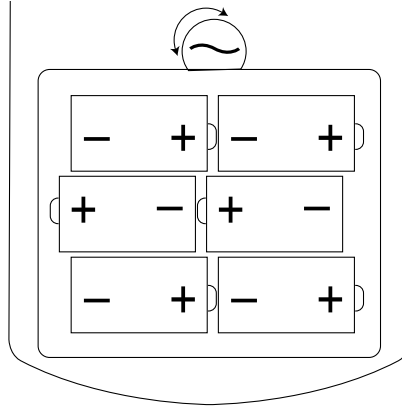

### BATTERY PRECAUTIONS

Follow these precautions when using batteries in this device:

1. Use only the size and type of batteries specified.
2. Be sure to follow the correct polarity when installing the batteries as indicated next to the battery compartment. Reversed batteries may cause damage to the device.
3. Do not mix different types of batteries together (e.g. Alkaline and Carbon-zinc) or old batteries with fresh ones.
4. If the device is not to be used for a long period of time, remove the batteries to prevent damage or injury from possible battery leakage.
5. Do not try to recharge batteries not intended to be recharged; they can overheat and rupture. (Follow battery manufacturer's directions.)

### AC OPERATION

To operate the unit using AC power, connect a 9V AC adapter (not included) to an AC outlet having 120V, 60Hz AC only. Plug the small end into the DC 9V jack on the unit and connect the other end into the AC outlet. The batteries are automatically disconnected when the AC adapter is used.

**CAUTION:** When not using AC power, disconnect the AC adapter from the wall outlet by pulling the plug (not the cord). Do not touch the AC adapter with wet hands and plug fully inserted without exposing any part of the blade.



## OPERATION

### TO PLAY THE RADIO

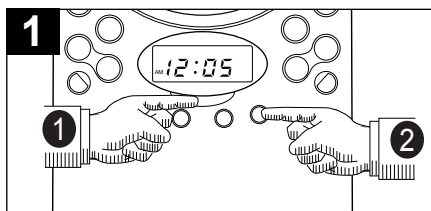

Press the POWER button ❶ to turn the unit on, then press the FUNCTION button ❷ repeatedly until TUNER appears in the display.

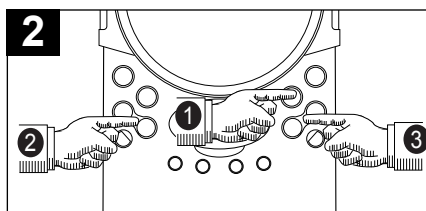

Press the BAND button ❶ to the desired band (AM or FM) and tune a station by pressing the TUNING/TIME SET buttons ❷. Adjust the VOLUME ❸ as desired.

#### Antennas

Turn the unit for best AM reception. Add external FM antenna wire for best FM reception.

### TO SET A STATION INTO MEMORY

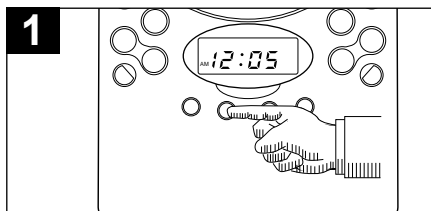

Tune a desired station as described in the previous section. Press the MEMORY button; the MEMORY indicator will blink in the display.

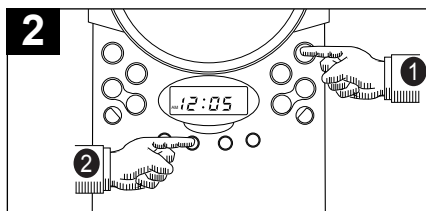

Press the MEMORY UP button ❶ to select a desired Memory location, then press the MEMORY button ❷ again; the MEMORY indicator will light solid and the station will be memorized.

### TO RECEIVE A STATION FROM MEMORY

To receive a station from memory, simply press the MEMORY UP button until the desired memory location appears in the display.

### CD DISPLAY BUTTON

Press the CD DISPLAY button to briefly show the time.

## OPERATION

### USING AN EXTERNAL UNIT

You can connect an external tape player, home stereo, etc. to this unit as follows:

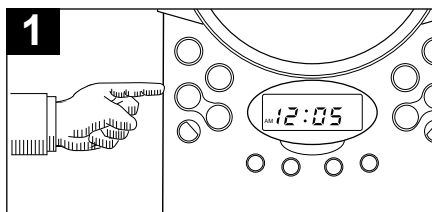

**1** Before making any connections, turn off the power to all equipment. Plug a connection cable (not included) between the AUX IN jack on the side of this unit and the external unit's OUT jack.

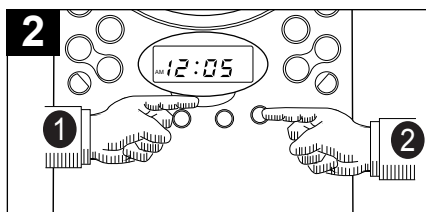

**2** Press the POWER button ❶ to turn the unit on, then press the FUNCTION button ❷ repeatedly until AUX appears in the display. Turn on power to the external unit and start playback.

### CD DISPLAY BUTTON

Press the CD DISPLAY button to briefly show the time on the display.

### TO INSERT A CD

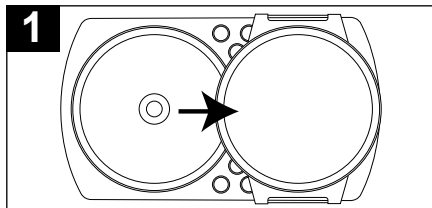

**1** Open the CD Compartment Door by sliding the CD Compartment down. Gently push a disc, label side up, onto the spindle until it locks in place and close the CD Compartment Door by sliding it up.

### TO REMOVE A CD

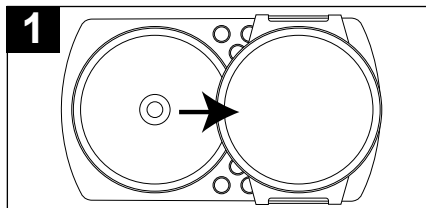

**1** Make sure the CD has stopped and open the CD Compartment Door by sliding the CD Compartment down. Hold the edge of the CD and pick it up.

## OPERATION

### TO PLAY A CD

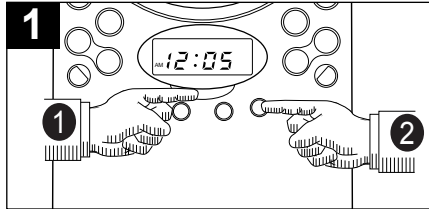

Insert a CD as described on the previous page. Press the POWER button ❶ to turn the unit on, then press the FUNCTION button ❷ repeatedly until CD appears in the display.

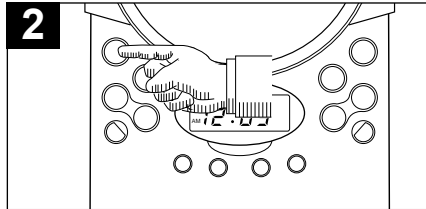

Press the PLAY/PAUSE (▶||) button to start playback.  
**TO PAUSE PLAYBACK**, press the PLAY/PAUSE (▶||) button again; the display will blink.

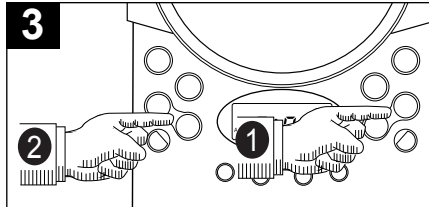

Adjust the VOLUME ❶ as desired. To **skip** forward or backward through the tracks on the disc, press the SKIP/SEARCH ◀◀ or ▶▶ button ❷. To **search** forward or backward through the tracks on the disc, press and hold the SKIP/SEARCH ◀◀ or ▶▶ button ❷.

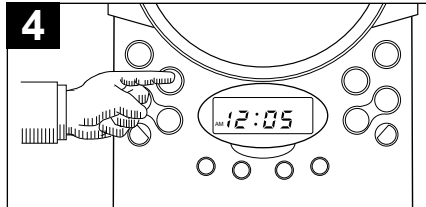

When the disc is through playing, it will stop. Press the STOP (■) button to stop the disc before it is finished.

#### NOTES:

- This unit is capable of playing standard CDs or 3" singles; no adapter is required.
- If a disc is inserted incorrectly, dirty, damaged or not present at all, the disc will not play and either "err" or "no disc" will appear in the display.
- To remove the disc, open the CD Compartment, hold the edge of the CD and lift it out.
- The maximum time of a CD is 74 minutes for this unit.

## OPERATION

### TO REPEATEDLY PLAY BACK ONE TRACK

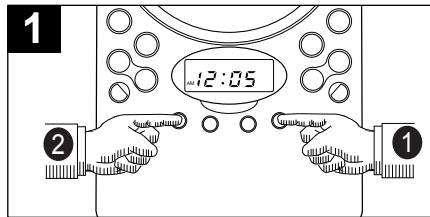

Turn the unit on and press the FUNCTION button ❶ repeatedly until CD appears in the display. Press the REPEAT button ❷ once; REPEAT will blink in the display.

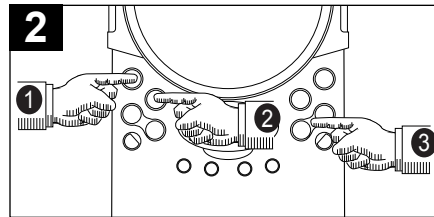

Press the PLAY/PAUSE (▶||) button ❶. The unit will then play the same track over and over until the STOP (■) button ❷ is pressed. Adjust the VOLUME ❸ as desired.

### TO REPEATEDLY PLAY BACK ALL TRACKS ON A CD

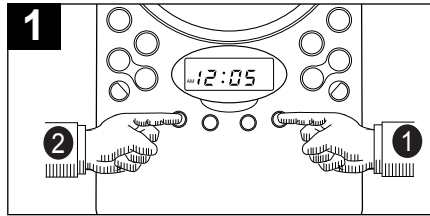

Turn the unit on and press the FUNCTION button ❶ repeatedly until CD appears in the display. Press the REPEAT button ❷ twice; REPEAT will light solid in the display.

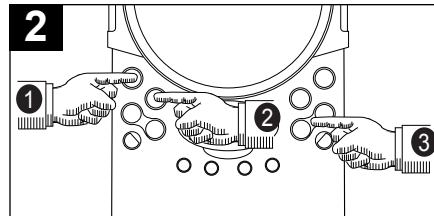

Press the PLAY/PAUSE (▶||) button ❶. The unit will then play all the tracks on the CD over and over until the STOP (■) button ❷ is pressed. Adjust the VOLUME ❸ as desired.

### RANDOM PLAYBACK

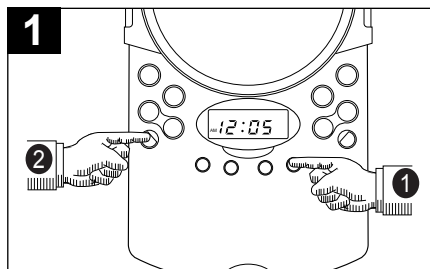

Turn the unit on and press the FUNCTION button ❶ repeatedly until CD appears in the display. With a CD inserted, press the RANDOM button ❷ once; RANDOM will light in the display and the unit will automatically start randomly playing the tracks on the CD.

## OPERATION

### TO PROGRAM THE MEMORY (UP TO 20 TRACKS)

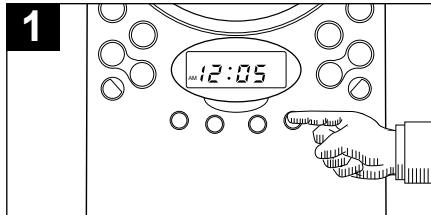

**1** Turn the unit on and press the FUNCTION button repeatedly until CD appears in the display.

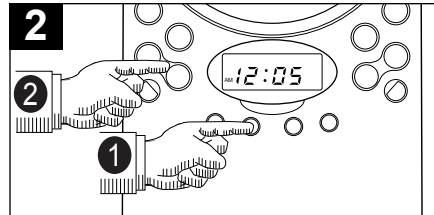

**2** Press the MEMORY button ❶, "P-01 01" will appear in the display. Within 8 seconds, press the SKIP/SEARCH ◀◀ or ▶▶ button ❷ to select the first desired track to program.

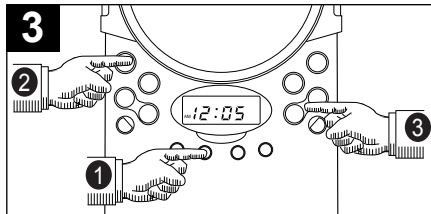

**3** Press the MEMORY button ❶ to memorize the track. Repeat steps 2 and 3 to program additional tracks up to a maximum of 20 tracks. Press the PLAY/PAUSE (▶||) button ❸ to begin program playback and adjust the VOLUME control ❹ as desired.

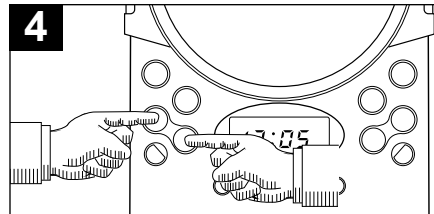

**4** To skip forward or backward through the programs, press the SKIP/SEARCH ◀◀ or ▶▶ button. When the disc is through playing, it will stop.

#### NOTES:

- Press the STOP (■) button to stop the disc before it is finished.
- As each program is played, the track number is shown in the display.
- Programming is the ability to preselect the order in which a series of tracks will be played.
- To change a program, press the MEMORY button to select the desired program to change, then press the SKIP/SEARCH ◀◀ or ▶▶ button to change the track.
- Each track may be stored in the program memory as many times as desired (up to 20 tracks).
- Press the MEMORY button to check the program track number.

## OPERATION

### TO SET OR RESET THE ACTUAL TIME

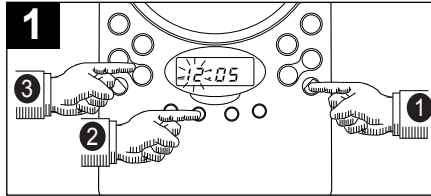

Turn off the unit or press the CD DISPLAY button ❶ so the Clock/Time is on the display, press the MEMORY button ❷; the hour digits will blink. Press the TUNING/TIME SET UP/DOWN button ❸ to set the present hour.

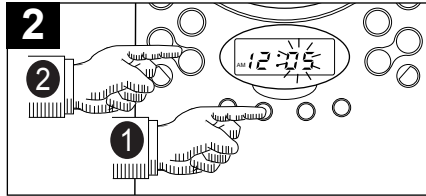

Press the MEMORY button ❶ again; the minute digits will blink. Press the TUNING/TIME SET UP/DOWN buttons ❷ to set the present hour. Press the MEMORY button ❶ again; the colon will begin blinking and the time will be set.

### TO ACTIVATE THE SLEEP FUNCTION

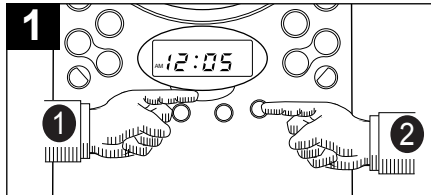

Tune the desired radio station or play a CD as previously instructed.

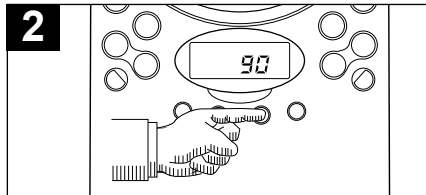

Press the SLEEP button once, "90" will appear on the display indicating the unit will play for 90 minutes and then shut off.

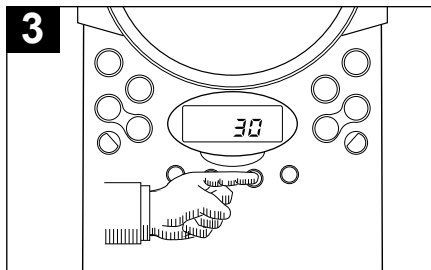

Press the SLEEP button once or twice more to decrease the playing time to 60 or 30 minutes respectively. To cancel sleep time, press the SLEEP button repeatedly until the normal CD or TUNER mode appears on the display.

## TROUBLESHOOTING GUIDE

If you experience a problem with this unit, check the chart below before calling for service.

SYMPTOM	CAUSE	SOLUTION
Unit will not turn on.	Weak or dead batteries.	Replace batteries.
	Wrong adapter being used	Use only center positive 9V adapter.
	AC adapter not connected.	Check AC adapter connection.
Disc will not play.	CD compartment not closed.	Close CD compartment.
	Disc inserted incorrectly.	Reinsert disc correctly.
	Dirty or defective disc.	Try another disc.
	Moisture condensation on disc.	Wipe disc with soft cloth.
Erratic CD playback.	Dirty or defective disc.	Clean or replace disc.
No sound.	Headphone plug inserted into headphone jack.	Unplug headphones.
	VOLUME control set to minimum.	Increase volume.
	Weak batteries.	Replace batteries.
	Defective disc.	Try another disc.
	FUNCTION is not set to the desired position.	Press FUNCTION button to the desired function.
Noise or sound distorted on radio.	Station not tuned properly for AM or FM.	Retune AM or FM broadcast station.
	Unit is not positioned correctly.	Rotate unit until best reception is obtained.

## CARE AND MAINTENANCE

### Caring for Compact Discs

- Treat the disc carefully. Handle the disc only by its edges. Never allow your fingers to come in contact with the shiny, unprinted side of the disc.
- Do not attach adhesive tape, stickers, etc. to the disc label.
- Clean the disc periodically with a soft, lint-free, dry cloth. Never use detergents or abrasive cleaners to clean the disc. If necessary, use a CD cleaning kit.
- If a disc skips or gets stuck on a section of the disc, it is probably dirty or damaged (scratched).
- When cleaning the disc, wipe in straight lines from the center of the disc to the outer edge of the disc. Never wipe in circular motions.

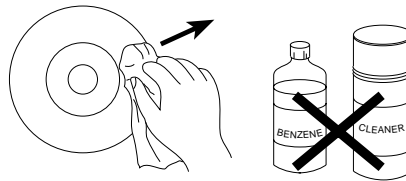
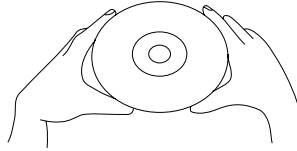

- This unit is designed to play only compact discs bearing the identification logo as shown here. Other discs may not conform to the CD standard and may not play properly.
- Compact Discs should be stored in their cases after each use to avoid damage.
- Do not expose compact discs to direct sunlight, high humidity, high temperatures, or dust, etc. Prolonged exposure or extreme temperatures can warp the disc.
- Do not stick or write anything on either side of the disc. Sharp writing instruments, or the ink may damage the surface.



### Cleaning the unit

- To prevent fire or shock hazard, disconnect your unit from the AC power source when cleaning.
- The finish on your unit may be cleaned with a dust cloth and cared for as other furniture. Use caution when cleaning and wiping the plastic parts.
- Mild soap and a damp cloth may be used on the front panel.



## LIMITED (AUDIO)WARRANTY

We at Memorex believe you will be pleased with your new product. Please read this Warranty Carefully. Memorex warrants this product to be free from manufacturing defects including original parts and workmanship for a period of ninety (90) days from the date of original purchase in, and if used in, the United States.

Should you find your unit is not operating properly during the terms of full coverage of this warranty, ninety (90) days, you should contact your original place of purchase for an exchange with a valid receipt. If necessary, Memorex will provide one of the following options (at Memorex's discretion), providing the manufacturing defect is verified along with the date of purchase.

- Repair service for ninety (90) days from date of original purchase at no charge for labor and parts at their authorized warranty service facility, providing the manufacturing defect is verified along with the date of purchase.
- Replacement of defective unit with either a new, refurbished, or equivalent model at no charge for ninety (90) days from date of original purchase.

This warranty is void if the product is:

- A) Damaged through negligence, abuse, misuse, accident, or acts of God.
- B) Used in commercial applications or retails.
- C) Modified or repaired by anyone other than Memorex or their expressly authorized representative.
- D) Damage resulting from the improper connection to equipment of other manufacturers.

This warranty does not cover:

- A) Cost incurred in the shipping of the product to and from the Memorex-authorized repair facility listed.
- B) Damage or improper operation caused by the failure to follow the operating instructions provided with the product.
- C) Routine adjustments to the product, which can be performed by the customer as outlined in the owner's manual.
- D) Signal reception problems caused by external factors.
- E) Products not purchased in the United States.
- F) Damage to the products used outside to the United States.
- G) Damage to audio cassette tapes.
- H) Damage to compact disc.

In the event that service is required under this warranty, please contact CUSTOMER SERVICE at 1-800-919-3647 or contact our website at [www.memorex.com](http://www.memorex.com).

THIS WARRANTY IS NON-TRANSFERABLE AND APPLIES SOLELY TO THE ORIGINAL PURCHASER AND DOES NOT EXTEND TO SUBSEQUENTLY OWNERS OF THE PRODUCT. ANY APPLICABLE IMPLIED WARRANTIES, INCLUDING THE WARRANTY OF MERCHANTABILITY, ARE LIMITED IN DURATION TO A PERIOD OF THE EXPRESSED WARRANTY AS PROVIDED HEREIN BEGINNING WITH THE DATE OF THE ORIGINAL PURCHASE AT RETAIL AND NO WARRANTIES, WHETHER EXPRESSED OR IMPLIED SHALL APPLY TO THE PRODUCT THEREAFTER. MEMOREX MAKES NO WARRANTY AS TO THE FITNESS OF THE PRODUCT FOR ANY PARTICULAR PURPOSE OR USE.

THE EXTENT OF MEMOREX'S LIABILITY UNDER THIS LIMITED WARRANTY IS THE REPAIR OR REPLACEMENT PROVIDED ABOVE AT THE SOLE DISCRETION OR MEMOREX. IN NO EVENT SHALL MEMOREX'S LIABILITY EXCEED THE PURCHASE PRICE PAID BY THE DIRECT, INDIRECT INCIDENTAL, FORESEEN, UNFORESEEN, SPECIAL, OR CONSEQUENTIAL DAMAGE ARISING OUT OF OR IN CONNECTION WITH THE SUE OF THIS PRODUCT.

THIS WARRANTY IS VALID ONLY IN THE UNITED STATES. THIS WARRANTY GIVES YOU SPECIFIC LEGAL RIGHTS, HOWEVER, YOU MAY HAVE OTHER RIGHTS WHICH MAY VARY FROM STATE TO STATE. SOME STATES DO NOT ALLOW LIMITATIONS ON IMPLIED WARRANTIES OR EXCLUSION OF CONSEQUENTIAL DAMAGE, THEREFORE THESE RESTRICTIONS MAY NOT APPLY TO YOU.

© 2000. Memorex is a registered trademark of Memorex Telex N.V.

WAITING FOR BACK COVER ARTWORK FROM SELVAN,  
PLEASE E-MAIL.

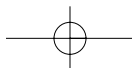
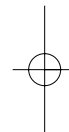
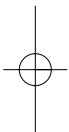

use memorex cover

WAITING FOR ARTWORK FOR COVER FROM  
SELVAN, PLEASE E-MAIL.

